

# Collier Elementary School Proposal

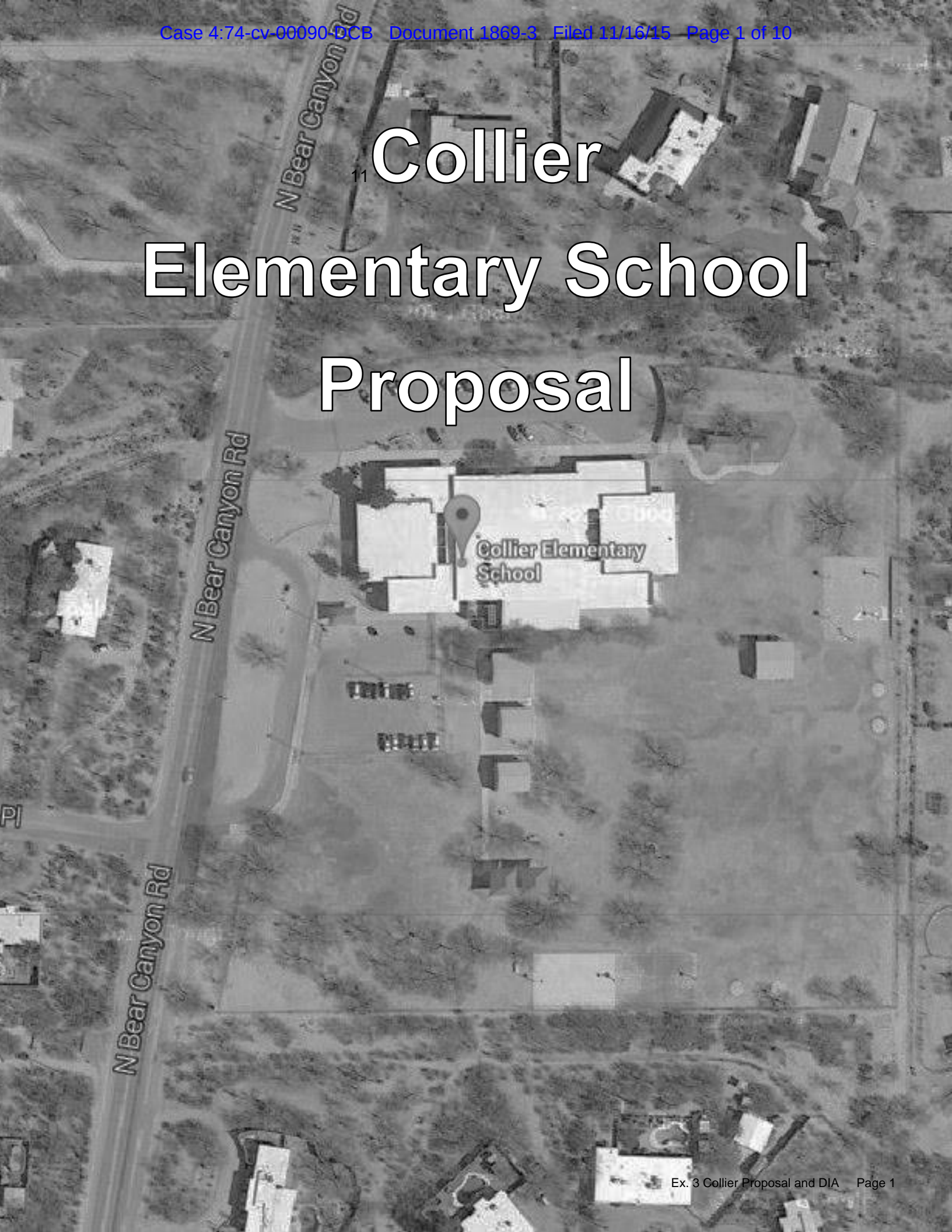

## COLLIER ELEMENTARY SCHOOL

### Proposal Description:

- Change K-5 to a K-6
- Immediate Needs: No renovations needed
- Long Term Plan: No renovations needed

### Integration Strategies:

**Pairing and Clustering:** Collier is geographically far from any other elementary school. Pairing or clustering Collier with another school to share a boundary is not feasible.

**Boundaries:** No boundary changes required; boundary changes would not increase integration

**Magnets:** Collier is not a magnet school, and the proposal would not significantly impact any surrounding magnet schools (the nearest magnet schools are more than five miles away).

**Open Enrollment (supported by incentive transportation):** Students living within the boundary of a Racially Concentrated school could attend Collier through open enrollment. For students whose enrollment would increase integration at Collier, the District would provide free transportation in the form of an express bus from a central location to Collier (perhaps combine 6<sup>th</sup> graders open enrolled to Collier with 7<sup>th</sup> and 8<sup>th</sup> graders open enrolled to Sabino, if Sabino is approved). An increase in non-Anglo students at Collier would move it towards the definition of an Integrated School

**Proposal-specific strategies to promote integration and/or other USP activities:** In 2014-15, Magee's student population was 46% Anglo, 13% African American, and 34% Latino). A reduction in Anglo student percentage and/or an increase in Latino student percentage would move Magee towards the definition of an Integrated School. Developing and offering enhanced ALE programs at Magee (AVID and/or partnerships with Sahuaro High School for pre-AP or Dual-Credit courses) could operate to attract more Latino students to Magee, and to prepare African American and Latino students for success in core classes and Advanced Learning Experiences (ALEs).

### Pros and Cons:

#### **Pros:**

- Increases enrollment at a school which is not racially concentrated
- Increase choice for parents and students in TUSD. By right, the students in these schools may still attend the middle school that currently serves them.
- Capture Collier 6th graders that now leave TUSD (35)
- Create STEM after school programs that feed into Magee's Odyssey of the Mind to attract diverse students to both schools
- Continue Collier's strong Exceptional Ed program into 6th grade
- Include multi-cultural and athletic after school programs to attract diverse students and to provide child-care for those taking an express bus
- Minimal cost

#### **Cons:**

- Prepare for 7th grade transition, versus 6th grade, into middle school
- No science lab for 6th graders, as they might have in middle school (use a science cart)

### Costs:

**Construction:** Immediate Needs \$20,000; Long Term Plan: \$0

#### **Transportation:**

- \$64,000 for an express bus (ride time 35 minutes) (costs shared with Fruchthendler)
- \$0 to add a Roskrige stop to an existing Collier route (ride time 1 hour)

**Marketing:** Included in overall School Choice marketing plan

## Collier Evaluation:

| Pos(+) | Neut. | Neg(-) | Criteria   |
|--------|-------|--------|--|
|        | X     |        | Demographics (i.e., race, ethnicity, exceptional ed., current and projected enrollment, current and projected development patterns, socio economic status, GATE and other) |
| X      |       |        | Targeted operating capacities  |
| X      |       |        | Current and planned instructional programs   |
|        | X     |        | Effects on integration   |
|        | X     |        | Student transportation   |
| X      |       |        | Feeder patterns  |
|        | X     |        | Fiscal impacts   |

## **TUCSON UNIFIED SCHOOL DISTRICT DESEGREGATION IMPACT ANALYSIS**

**Action:** Collier as a K-6 School

### **Summary**

Collier Elementary School is a K-5 school that serves the northwest area of TUSD just east of Sabino Creek and south to the Tanque Verde Wash. This is an analysis of the racial-ethnic composition of Collier as a K-5 school, the impact of adding a 6th grade to that school, and estimated impacts of the proposed change to the District's obligations under the USP.

### **A. Analysis of the impact of the requested action on the District's obligation to desegregate.**

#### **Current K-5 Enrollment at Collier**

As shown in the Table 1 there are approximately 200 students at Collier—30 to 40 students per grade. The racial-ethnic composition is 62% Anglo and 31% African American and Latino.

Based on 2010 census data, for the Collier Area, there are over 20 students per grade in the K-5 level who do not attend TUSD schools and over 40 who do not attend TUSD schools in the 6<sup>th</sup> grade (see the map below).

#### **Impact on Collier as a K-6 School**

Based on typical transition rates from 5<sup>th</sup> grade to 6<sup>th</sup> grade for K-8 and K-6 schools, the change would add approximately 20 to 30 students to Collier, resulting in 1 class. However, with the strong potential to attract students who attend non-TUSD schools, the projections are based on adding 35 students from the 135 total middle-school-age students in the Collier area in the 6<sup>th</sup> grade. Those impacts are shown in Table 1.

The school has capacity for the additional students. Not counting the portables, the school has a capacity of 400 as currently used and the capacity could be increased to 425 by scheduling resource programs to share rooms and or portables. Now, with 200 students, Collier is at 50% utilization; with the additional students it would increase to 58% utilization rate.

The change is expected to have very little impact on the racial ethnic composition of Collier because the population that would attend the 6<sup>th</sup> grade has essentially the same composition as the current K-5 population.

**Table 1**

## Change Component

| School (grades)                        | Anglo | Afr Am | Hisp | Nat Am | Asian-PI | Multi | Total |
|--|-------|--------|------|--------|----------|-------|-------|
| Continue at Collier (6 <sup>th</sup> ) | 23    | 2      | 8    | 1      | 0        | 1     | 35    |
| %                                      | 64%   | 6%     | 24%  | 2%     | 1%       | 3%    |       |

## Collier Impacts

| School (grades)         | Anglo | Afr Am | Hisp | Nat Am | Asian-PI | Multi | Total |
|-------------------------|-------|--------|------|--------|----------|-------|-------|
| Collier (current K-5)   | 122   | 6      | 49   | 4      | 2        | 14    | 197   |
| %                       | 62%   | 3%     | 25%  | 2%     | 1%       | 7%    |       |
| Collier (projected K-6) | 145   | 8      | 57   | 5      | 2        | 15    | 232   |
| %                       | 63%   | 3%     | 25%  | 2%     | 1%       | 6%    |       |

Impact of an Express Bus on Collier as a K-6 School

A survey of 5<sup>th</sup> graders in racially concentrated middle school areas indicated that 82 parents (25% of respondents) may be interested in having their children attend the Collier if a 6<sup>th</sup> grade were added and if transportation were provided. If this were applied to all 7 grades that might be able to attend Collier (K-6), there would be over 500 parents interested. For the purposes of this analysis, we have assumed there would be one bus with 30 students (approximately 5% of the potential indicated by the survey).

The results shown below indicate that the additional students from racially concentrated schools areas would move the school 7% to 8% closer to being integrated in two racial-ethnic categories.

**Table 2**

| Change (grades)   | Anglo | Afr Am | Hisp | Nat Am | Asian-PI | Multi | Total |
|-------------------|-------|--------|------|--------|----------|-------|-------|
| Express Bus (K-6) | 0     | 1      | 26   | 2      | 0        | 1     | 30    |
| %                 | 0%    | 3%     | 87%  | 7%     | 0%       | 3%    |       |

| School (grades)                         | Anglo | Afr Am | Hisp | Nat Am | Asian-PI | Multi | Total |
|---|-------|--------|------|--------|----------|-------|-------|
| Collier (projected K-6)                 | 145   | 8      | 57   | 5      | 2        | 15    | 232   |
| %                                       | 63%   | 3%     | 25%  | 2%     | 1%       | 6%    |       |
| Collier (projected K-6 w/ express bus)) | 145   | 9      | 83   | 7      | 2        | 16    | 262   |
| %                                       | 55%   | 3%     | 32%  | 3%     | 1%       | 6%    |       |

Impacts on Magee Middle School, Sabino High School and Other Schools

The impacts on Magee and other schools are reported separately in the Sabino DIA.



### Map of the Area

The following shows the Sabino Area, outlined in red, and within it, the Collier Area is northeast of Fruchthender. The Collier K-5 Area is wholly within the Sabino HS Area. The Sabino HS Area also includes the Fruchthender K-5 Area and portions of Bloom, Hudlow, and Whitmore. At the middle school level, it includes a large portion of Magee and, to a much lesser extent, Booth-Fickett.

The numbers within each area show the total number of middle-school-age students in 2010 who did not attend TUSD schools.

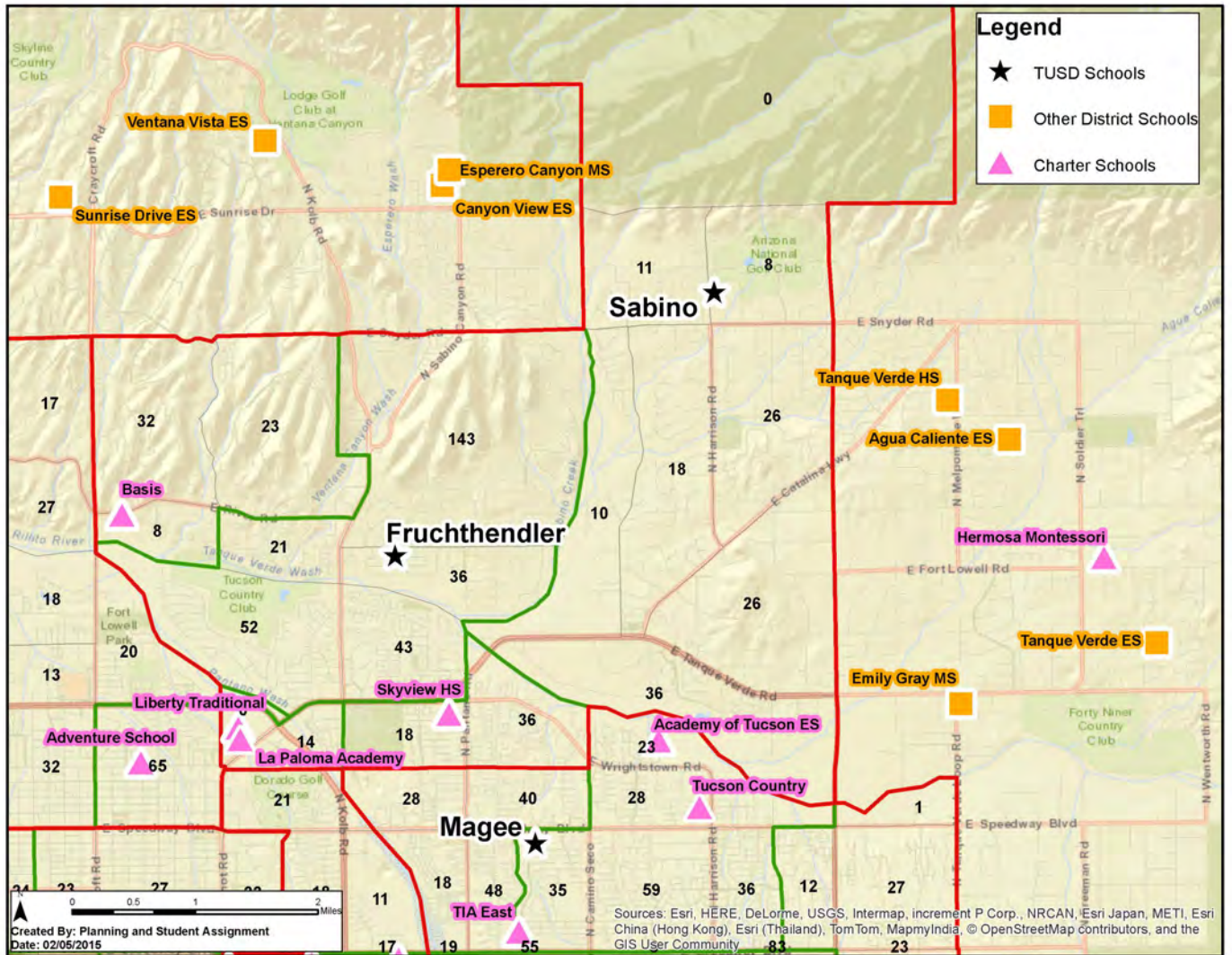

**Renovation Costs**

- Immediate Needs: \$20,000
- Long Term Plan: \$0

**Transportation Costs**

- \$64,000 for an express bus (ride time 35 minutes) (costs shared with Fruchthendler)
- \$0 to add a Roskruge stop to an existing Collier route (ride time 1 hour)

**B. Analysis of how the proposed change will impact the District's obligations under the USP**

The District, Plaintiffs, and Special Master have identified 65 USP implementation activities, organized by the ten USP sections I-X. Below, the District analyzes the potential impact of the proposed grade configuration change on the District's obligations under each of the ten USP sections:

- 1. Compliance** No potential impact.
- 2. Student Assignment** The proposal itself will result in minimal potential impact to Collier itself, as shown in Section A above. However, an extremely low number of middle-school-aged students from the Collier area attend District schools for 6<sup>th</sup> through 8<sup>th</sup> grade. Retaining more of these students at Collier (students who now attend non-District schools) will offer additional opportunities to increase integration districtwide by broadening the pool of available students to which the District can more directly engage in marketing, outreach, and recruitment activities. As an ancillary measure, the District is proposing to develop ALE programs (AVID and/or partnerships with Sahuaro High School for pre-AP or Dual-Credit courses) at nearby Magee Middle School to increase its attractiveness to Latino students and families to increase integration at Magee.
- 3. Transportation** Positive impact if the express bus is added; students living within the boundary of a racially concentrated school, whose enrollment at Collier would improve integration, would receive free transportation to Collier via an express bus.
- 4. Admin/Cert Staff** No potential impact.
- 5. Quality of Education** Positive impact by the addition of AVID and AP programs at Magee to prepare African American and Latino students for success in core classes and Advanced Learning Experiences (ALEs) such as GATE and pre-AP classes..
- 6. Discipline** No potential impact.
- 7. Family and Community Engagement** . Currently, many students and families living in the Collier area disengage from the District after 5<sup>th</sup> grade, frustrating efforts at family engagement, including: marketing, outreach, and recruitment; ALE, UHS, and dual-language recruitment ; and sharing information about college, career, and other opportunities available through the District. Creating a K-6 school will likely improve

family engagement and participation at Collier, translating to increased student retention, improvements in educational outcomes, reductions in disciplinary issues, and improved culture and climate.

8. **Extracurricular Activities** As the enrollment of Collier increases, so to do the opportunities to offer a wider variety of extracurricular activities which afford students opportunities to engage in interracial contact in positive settings of shared interest.
9. **Facilities and Technology** No potential impact.
10. **Accountability and Transparency** No potential impact.

### **C. Notes on the Above Demographic Analysis**

- All of the projections are estimates based on current patterns of choice. There is little data on preferences for 6<sup>th</sup> grades in an elementary school. The exception is Drachman K-6 which has a 5<sup>th</sup> to 6<sup>th</sup> grade transition of 60% to 80%. The 5<sup>th</sup> to 6<sup>th</sup> transition rates at K-8 schools (50% to 80%) are similar.
- The above estimates are based on current TUSD students. Because K-8 capture rates (TUSD students/total school age population) are less than 60% in the subject areas, there is a potential to attract students who do not currently attend TUSD schools. This is especially true for middle-school-age students. As shown in the table below, one-quarter of the Collier 5<sup>th</sup> graders in SY2013-14 did not attend TUSD schools in 6<sup>th</sup> grade the following year.

| Transition of Collier 5 <sup>th</sup> Graders into 6 <sup>th</sup> Grade |            |
|--|------------|
| School   | Enrollment |
| Not in TUSD  | 8          |
| Gridley  | 1          |
| Pistor   | 1          |
| Magee  | 23         |

**Correction:** The transition data above is different than the data shown in the previous version of the Collier DIA because that data (below) showed the transition for all of the 5<sup>th</sup> graders in the Collier Attendance Area even if they didn't attend Collier. That data illustrated even more the loss of middle-school-age students—one-half of the Collier Attendance Area 5<sup>th</sup> graders in SY2013-14 did not attend TUSD schools in 6<sup>th</sup> grade the following year.



| Transition of Collier Area 5 <sup>th</sup> Graders into 6 <sup>th</sup> Grade |            |
|---|------------|
| School  | Enrollment |
| Not in TUSD   | 35         |
| Dodge Magnet  | 1          |
| Fickett Magnet  | 1          |
| Gridley   | 1          |
| Magee   | 28         |

**COLLIER K-6 PARENT SURVEY SUMMARY**

Parent-Link Phone Survey

Questions for parents of 5th graders who live in the attendance areas of Racially Concentrated middle schools, and who would be eligible for incentive transportation to Magee:

Magee Middle School is an eastside school with strong academics and an outstanding Odyssey of the Mind competition group. Would you be interested in free transportation to Magee Middle School?

Yes 140      No 240

Collier is a tight-knit community of learners on the northeast side of Tucson. Would you be interested in free transportation to Collier if sixth grade were added?

Yes 82      No 244